

ENGLISH



Superior sushi shaping technology that creates the handmade texture and superior taste of sushi made by a professional chef.

Supporting 7 Languages

LCD operation touch panel can be displayed in English, French, German, Spanish, Korean, Chinese, and Japanese by user selection on panel.

Ultimate and Fluffy Shari (Rice) Ball

It creates low density (patent pending) and high quality Shari (Rice) ball using our proven design for measuring and creating a traditional shape rice ball without kneading, damaging or cutting the rice.

Reverse turntable model SSN-FRX

For the varieties of kitchen layout needs, reverse (clockwise direction) turntable model SSN-FRX is also available.

Compact Sushi Machine SSN-FLX



Features

- Language for LCD operation touch panel can be selected from major languages (English, French, German, Spanish, Korean, Chinese, and Japanese) by user selection on panel.
- Compact in design, and easy work to replenish a rice hopper with Shari (Rice).
- It makes fluffy Shari (Rice) ball that are a low density (patent pending) and high quality Shari (Rice) ball without kneading rice.
- Creating soft Sushi without crashing and cutting the rice grains by original shutter blade shape.
- Flat LCD touch panel makes easy operation and highly visible words.
- Reduction of the number of cleaning parts for maintenance. Simple structure leads to sanitation, cleanness, easy assembling and disassembling.
- Softness and weight of the Shari (Rice) ball can be adjustable on touch panel.

Specification

Model

SSN-FLX (FLX: Counterclockwise Turn FRX: Clockwise Turn)

Input

AC120-240V, 50-60 Hz Single phase (machine with ETL mark)

AC100-240V, 50-60 Hz Single phase (machine without ETL mark)

Power Consumption

30W

Power Connection Cable

Length: 2m Plug: US Type, BF Type, CEE Type (selectable)

Capacity

2,000 2,500 3,000 3,600 pieces per hour (selectable)

Weight per piece

Minimum 15g to maximum 25g (Adjustable)

Hopper Capacity

10 Little (approx. 6Kg) of cooked rice

Machine Dimensions

350W x 518D x 619H (mm)

Machine Weight

25Kg

Dimensions

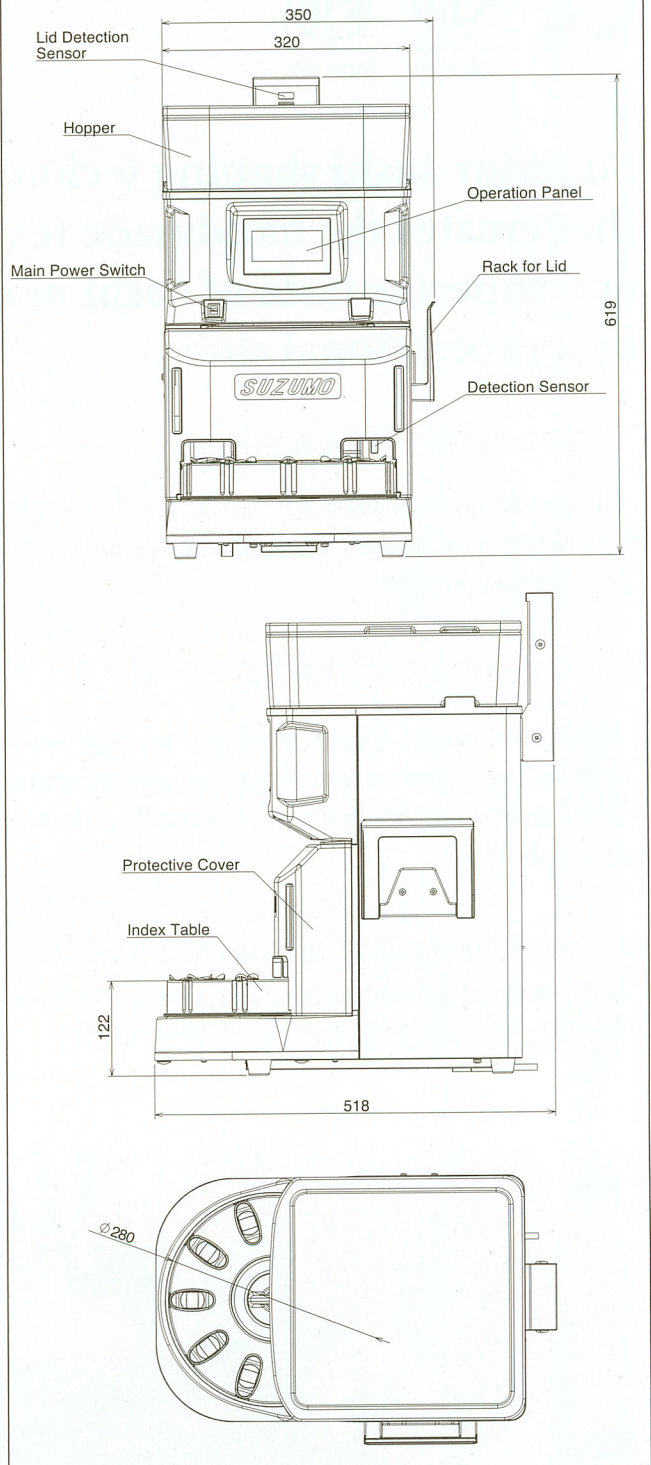

*Designs and specifications subject to change without notice.

*Please follow the instruction in the operation manual when handling the machine.

*While capacity expresses the machine's performance capabilities, it is predicated upon the machine being operated correctly.



Suzumo Machinery Co., Ltd.

Overseas Business Division

2-23-2, Toyotamakita, Nerima-ku,

Tokyo 176-0012, Japan

Tel. +81 3-3993-1407 Fax. +81 3-3993-1756

e-mail overseas@suzumo.co.jp

URL <http://www.suzumokikou.com>

< Contact in North America >

Suzumo International Corporation

379 Van Ness Ave., Suite 1406

Torrance, California 90501, U.S.A.

Tel. +1 310-328-0400

Fax. +1 310-328-2700

e-mail sic@suzumokikou.com